

Which
side
of the
window
will you
be on ?

Which
side
of the
window
will you
be on ?

Gazing
in with
envy or
gazing
out with
pride ?



SAI NIRVANA
DOWNTOWN
THE EPITOME OF LUXURY

An architectural rendering of the Sai Nirvana building, a modern commercial hub. The building features a prominent, curved, white facade with a large glass section on the ground floor. The glass reflects the surrounding environment and shows the interior of the building, which appears to be a multi-story retail or office space. The building is set against a clear blue sky. In the foreground, a group of people is walking on a paved area, providing a sense of scale and activity. The overall design is sleek and contemporary, with a focus on clean lines and a mix of materials like white panels and dark glass.

About Us

History remembers pioneers, those that have the foresight to see opportunity before it begins to gleam. Luckily with Sai Nirvana, opportunity is accompanied by an invitation for the chosen elite.

An urban homage to the eclectic energy of Kalyan, Sai Nirvana is the first of its kind modern, sprawling commercial hub with state-of-the-art infrastructure hosting retail outlets, offices, cafes and restaurants.

Crowned by a residential tower, Sai Nirvana is poised to become the most coveted, centrally located retail destination for over a million residents every day and change the Kalyan skyline forever.



Magnificent triple-heighted atrium lobbies that instantly invoke a sense of grandeur

Centralized air conditioning throughout the premises that maintains a pleasant and inviting atmospheric balance



A bouquet of configurations from 200 to 5000 sft. That allow you to choose the size that suits your vision

From the majestic marble quarries of Italy, every corridor has been paved with authentic Italian marble to give you the high-street shopping experience your customers have only dreamed of

- Ceiling Height 14ft
- Hazzle Free Walking Zone
- 24 Hours C.C.T.V Security
- Ample Car Parking Area
- 24 Hours Power Back Up
- Fully Air Conditioned Shopping arena
- Customizable Units
- Hightec Security Features
- High Speed Capsule lifts
- High Speed Elevators



Nestled in the heart of Kalyan, it is a mere stone's throw away from all major transport hubs (Kalyan and Shahad stations)

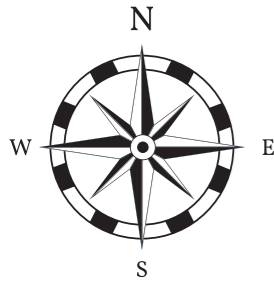

Ground Floor

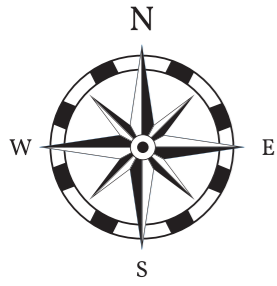

First Floor

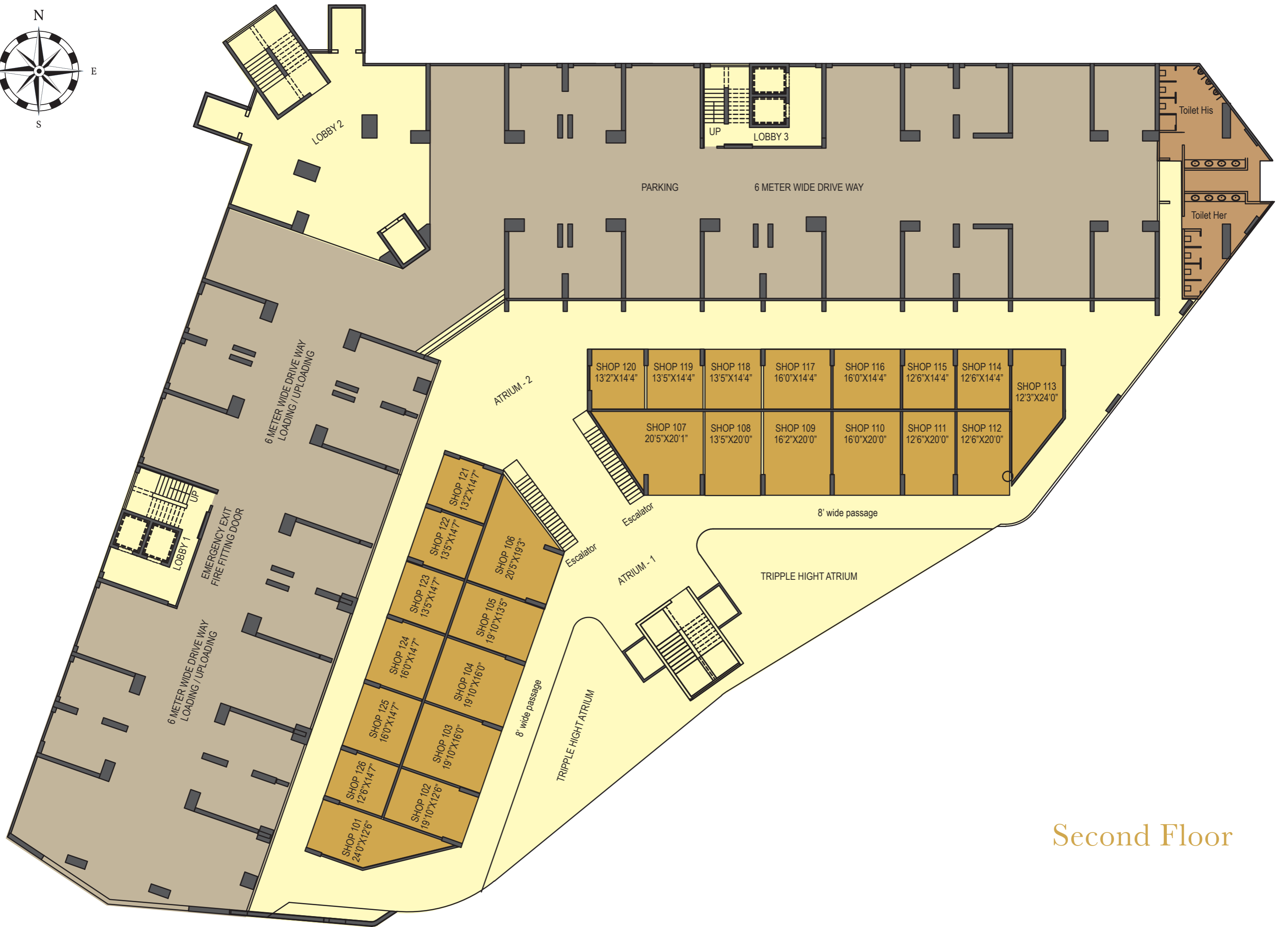
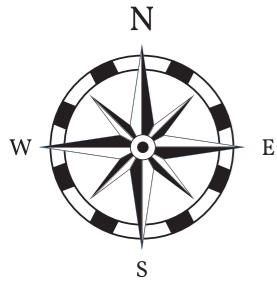

Second Floor

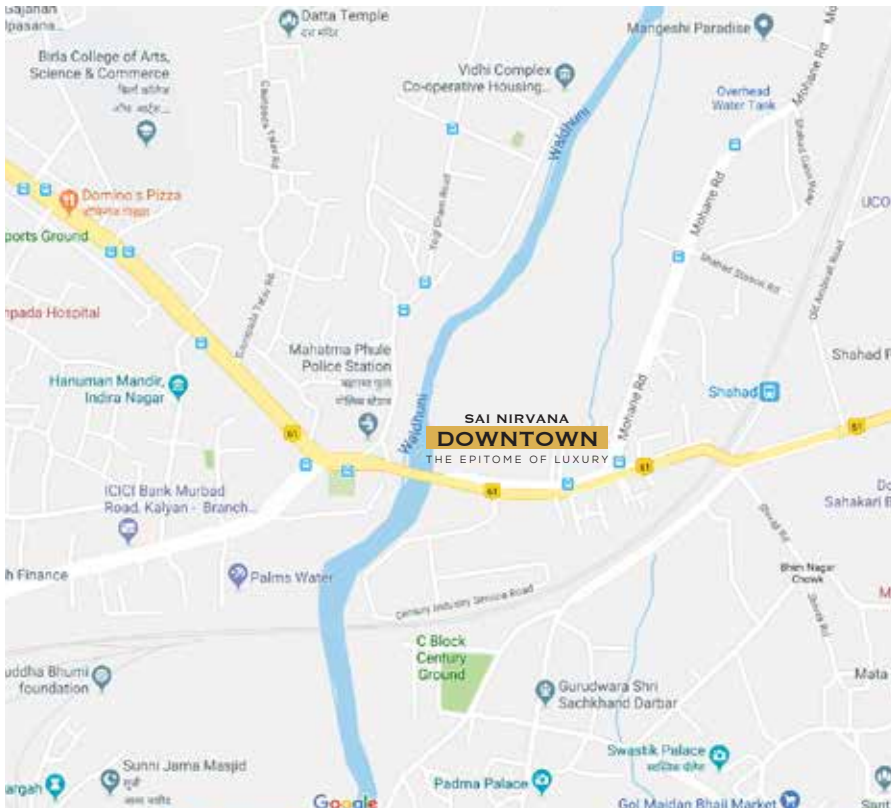

SAI NIRVANA
DOWNTOWN
 THE EPITOME OF LUXURY



PROJECT BY
 SHANKLESHA CONSTRUCTION

Corporate office: 101-103, Vikas heights, opp. HDFC Bank, Santoshi mata road, Kalyan (W) 421301.
 Site address: Sai nirvana, opp. century rayon, near shahad station, village shahad, Kalyan (W), 421301.

Email: inquiry@sainirvana.in / sales@sainirvana.in | Call: 0251-220-2770, 0251-231-2044 | +91 9819 42 2270

www.sainirvana.in



Disclaimer: The developers reserve the right to change plan, amenities and specification without prior notice or obligations. The perspective view shown here is an artist's conception of the development.